

*Precision Fit*  
**QuadraTherm™**  
 COMPLETE OEM STYLE SEAT HEATER KIT

Part#  
**PH-Q2-CA**

**Split Rectangular Component Pad**  
**Dimensions:**  
**25.5cm (L) x 12.5cm (W)**  
*each component*



**Modular System Design**

Thermal Wire Resistors  
 Split Rectangular Components

NO PAD MODIFICATION

Turn-To-Fit  
 BETWEEN  
 Listing Channels

**Part# PH-Q2-CA**  
*complete kit*

Fig. i: Single Pad Shown

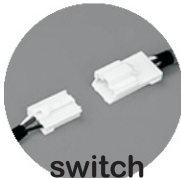

**Unique  
 Connector Pairs  
 Make It  
 EASY  
 To Get  
 Connected**

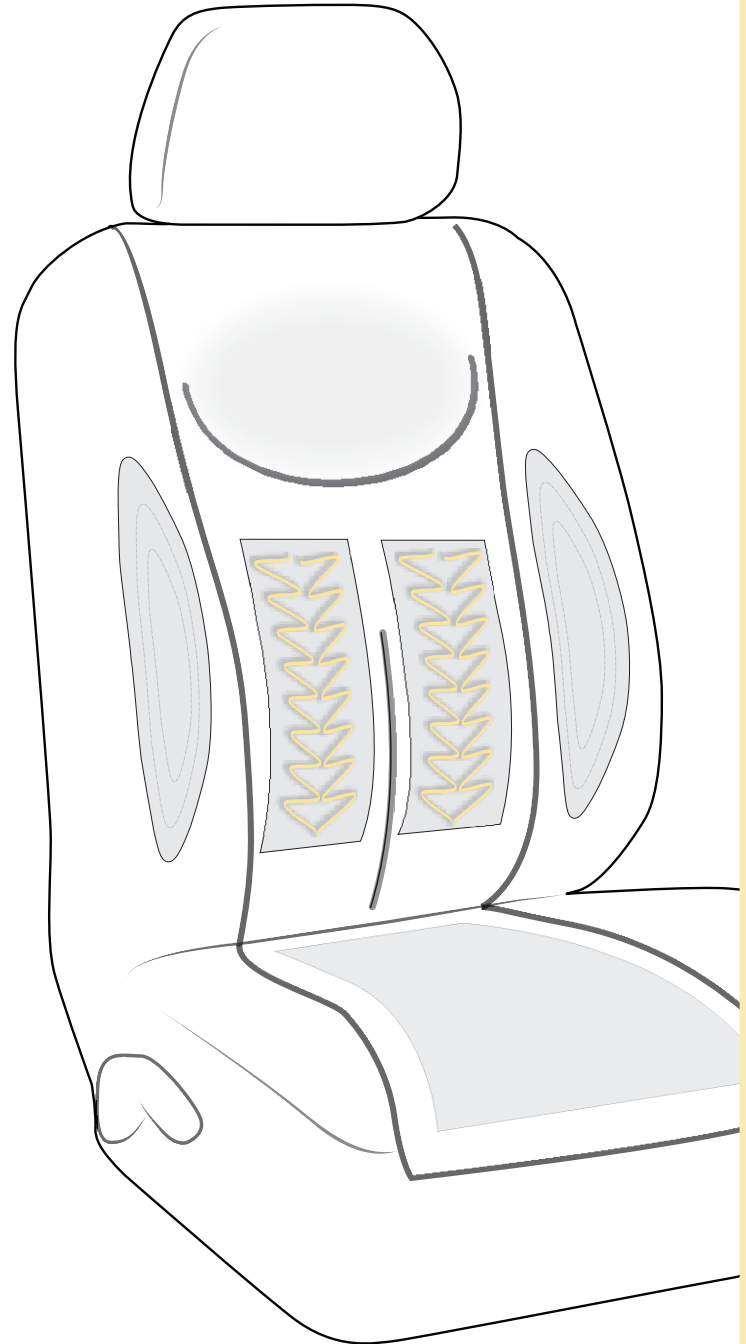

**PACIFIC HEAT**  
*Seat Heater System*

Pacific Restyling Products would like to introduce you to a better solution to streamlining your aftermarket automotive seat heater service



## Flexible Split Component Wire Elements

- Thermal contiguous wire element build
- Super-low profile thermostats
- Shielded wire leads/extensions
- Virtually undetectable under factory cloth upholstery
- FMVSS Compliant (FR302)

## Modular Relay Harness Design

- Unique connection interfaces on all harness components

## No Pad Alteration

- "No-Cut" thermal elements give the installer the advantage of an efficient install done with 100% confidence and 0% stress !
- Precision-fit pads are a turn -to-fit in design – giving you the flexibility to adapt your pad layout to suit listing channels of any style:
  - Hog-ring/Cable Tie & Wire/Plastic Anchor Points
  - Velcro Hook & Loop Strip Fasteners
  - Plastic Snap-In Tracks

Designed for speed & simplicity while retaining the versatility and high quality performance level necessary for TODAY'S competitive automotive aftermarket scene !

COMPLETE OEM STYLE SEAT HEATER KIT

\*\*\*Not For Use With Bonded Style Upholstery\*\*\*



**TO ENSURE OPTIMAL USER SAFETY & EQUIPMENT PERFORMANCE  
ONLY INSTALL PACIFIC HEAT SEAT HEATERS UNDER  
REMOVABLE UPHOLSTERY COVERS IN GOOD CONDITION:  
NO RIPS, TEARS, HOLES, OR OTHER DAMAGE FEATURES**

- **Have your seat heater kit installed by a qualified technician or installer**
  - Use original Pacific Heat Seat Heater components only
  - Disconnect vehicle battery terminals. Be sure to take note of any electronics security codes (navigation system, etc) prior to disconnection. After disconnecting battery WAIT 10 MINUTES to allow capacitor to discharge. Power will be maintained to safety systems.

**This equipment is for installation  
UNDER REMOVABLE UPHOLSTERY ONLY  
and should be adhered to the underlying seat foam.  
Do not install Pacific Heat under bonded seat skins.**

**IMPORTANT**  
Please Read

The installation method laid out in this manual affords the highest level of user safety and optimal performance of this equipment. Warranty claims will only be considered first and foremost when the installation procedure and method presented herein is fully adhered to.

An electronic copy of this manual can be found online at  
<https://pacificrestyling.com/pages/equipment-manuals>

# Pacific Heat Part Numbers & Accessories

Part #	Pacific Heat Seat Heater Systems (updated 05 -2024)	
PH-Q2-CA	<p><b>Pacific Heat QuadraTherm Thermal Wire Aftermarket OEM Style Seat Heater</b>            Kit Incl. 2 Rectangular Split Component Pads (25.5cm x 12.5cm each component);            Dual Temperature Switch, Relay Harness, Fuse w/Holder &amp; Installation Guide  <i>Fuse Size 7.5A. Pad substrate is FMVSS Compliant (FR302).</i>  <i>Assembled In Canada From Domestic &amp; Imported Components</i></p>	<p>PH one complete kit:             Outfits 1 seat upper backrest and lower seat cushion             2x PH-Q2-CA are needed to outfit Front row driver and Right side passenger</p>
SH-B-03	<p><b>Pacific Heat Accessory Seat Heater Pads – Bolster Mounted –</b>  <i>For placement on cushion or backrest bolster area. Pads are split-component style And have a dual Y-connector pad lead to facilitate usage options.</i>  <i>This alternate style pad provides a workable solution when surface mounted Airbag sensors are present. Package includes 2 split component oval heating elements (33cm L x 9cm max width, each oval component) &amp; Installation guide.</i>  <i>For use with Pacific Heat Seat Heaters. Made in China</i></p>	PH Accessory
SH-R-03sw	<p><b>Universal Round Rocker-Style Dual Temperature Seat Heater Switch</b>  <i>38cm pigtail, High/Low LED Illumination, 23mm Diameter, 4-pin Linear Connector</i>  <i>For use with Pacific Heat Seat Heater Systems. Made in China</i></p>	PH Accessory Round Bezel
SH-R-SWs	<p><b>Universal Square Bezel Rocker-Style Dual Temperature Seat Heater Switch</b>  <i>38cm pigtail, High/Low LED Illumination, 23mm Diameter, 4-pin Linear Connector</i>  <i>For use with Pacific Heat Seat Heater Systems. Made in China</i></p>	PH Accessory Square Bezel
SH-R-HNSc	<p><b>Complete Central Wiring Relay Harness</b>  <i>Incl. Socket Harness, 5-Pin Automotive Relay, Round Switch and Fuse/Fuse Holder</i>  <i>For use with Pacific Heat Seat Heater Systems.</i></p>	PH Accessory Default Switch for this part number: ROUND Bezel
SH-R-EXTs	<p><b>Switch Extension Wiring</b>  <i>Additional wire length to extend the switch lead connection by 107 cm.</i>  <i>For use with Pacific Heat Seat Heater Systems. Made in China</i></p>	PH Accessory
SH-R-EXTp	<p><b>Pad Extension Wiring</b>  <i>Additional wire length to extend the pad lead connection by 43 cm.</i>  <i>For use with Pacific Heat Seat Heater Systems. Made in China</i></p>	PH Accessory

**ALSO AVAILABLE:**



## Part# PDM-ME1 POWER DISTRIBUTION BYPASS MODULE

*? Trying to FIND POWER for your install?  
It's a trouble free task with our PDBM*

- **Avoid System Interference With Your 12V Automotive Installations**
- **Source CLEAN Power Directly from your Alternator or Battery !**

**Single Accessory Installation  
or Combined Load Up To 25A**

## FUSE STACKERS Power Distribution Installation Accessories *No Place For Another Fuse? Try Our Fuse Stackers !*

**SOLD in 10 Packs\*\***

**For Mini Fuse** Part# F-ATMN-10

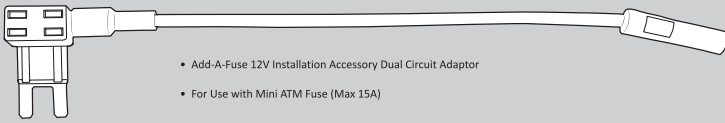

- Add-A-Fuse 12V Installation Accessory Dual Circuit Adaptor
- For Use with Mini ATM Fuse (Max 15A)

**For Low-Profile Mini Fuse** Part# F-LPMN-10

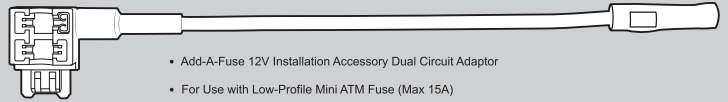

- Add-A-Fuse 12V Installation Accessory Dual Circuit Adaptor
- For Use with Low-Profile Mini ATM Fuse (Max 15A)

**For Micro2 Fuse** Part# F-MCR2-10

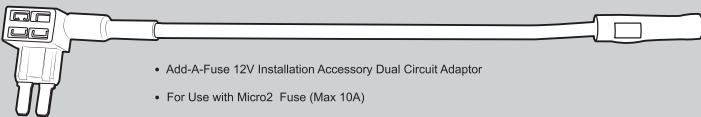

- Add-A-Fuse 12V Installation Accessory Dual Circuit Adaptor
- For Use with Micro2 Fuse (Max 10A)

**For Standard Fuse** Part# F-ATCN-10

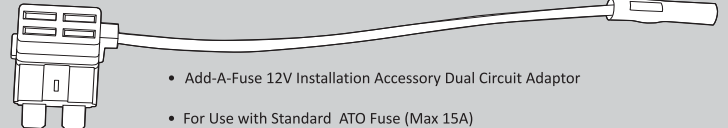

- Add-A-Fuse 12V Installation Accessory Dual Circuit Adaptor
- For Use with Standard ATO Fuse (Max 15A)

**\*\*fuses not included with device**

**Contact Your Supplier  
For More Information On These Products**

# 1

## KIT COMPONENT LIST

# PH-Q2-CA

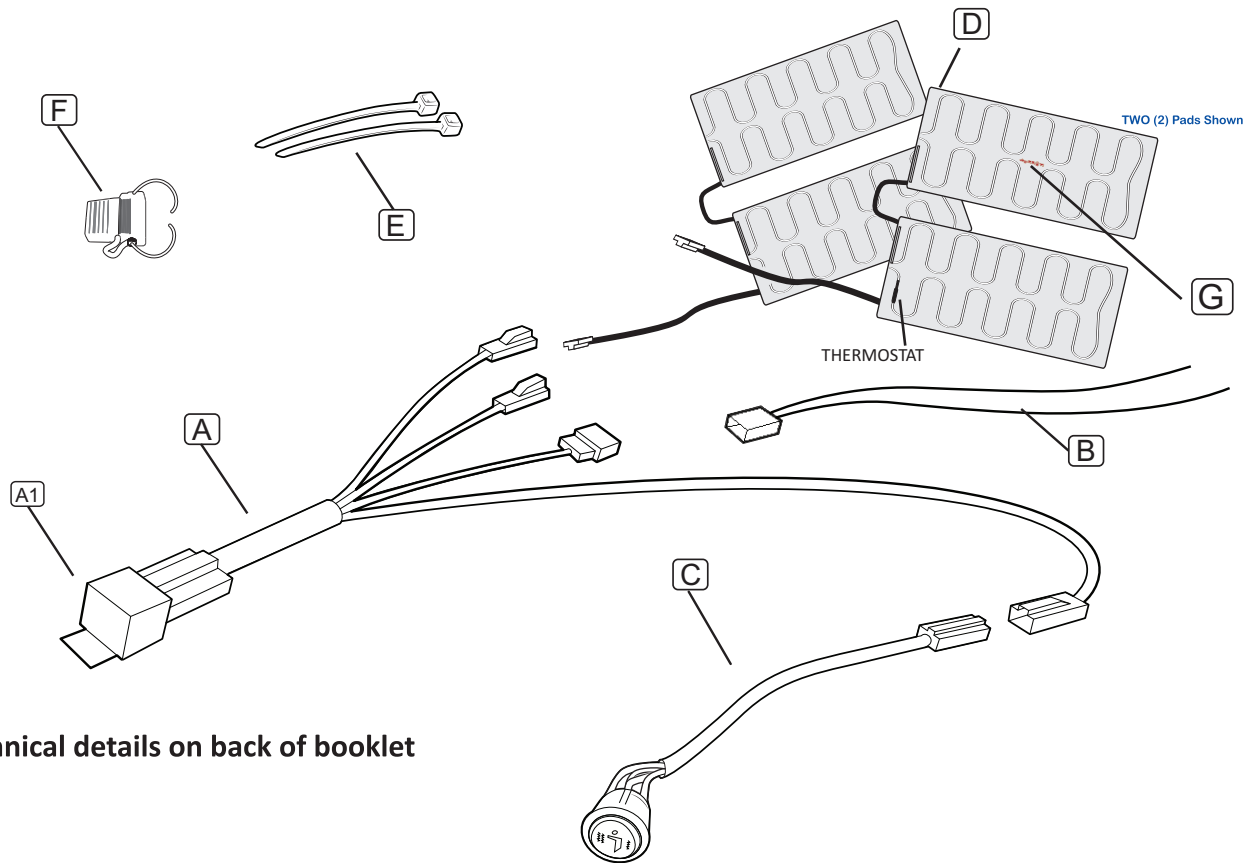

\*technical details on back of booklet

- A** Central Wiring Harness Assembly  
**A1** 5 Pin Automotive Relay

- B** Power/Ground Wire Leads

- C** Dual Temperature Round Rocker Switch  
 Black with white seat heater symbol  
 Requires a 23 mm Drill Hole ( $\frac{13}{16}$ " )

- Illuminates RED on HIGH Setting
- Illuminates GREEN on LOW Setting

- D** Thermal Wire Elements

***This kit contains a total of 2 (two) heater pads.***  
 Non Woven Synthetic Fibres (FMVSS Compliant (FR302))

- Single Pad Dimensions:

Each Single Pad has two (2) rectangular components  
**Component Dimensions**  
 L: 255 mm; W: 125 mm, edge to edge (~ 10" x 5")

- E** Cable Ties ("Zip" Ties)

- F** Fuse Holder  
 Fuse Included (7.5A)

- G** PAD ID # STAMP

**IMPORTANT**  
 Please Read

The installation method laid out in this manual affords the highest level of user safety and optimal performance of this equipment. Warranty claims will only be considered first and foremost when the installation procedure and method presented herein is fully adhered to.

An electronic copy of this manual can be found online at  
<https://pacificrestyling.com/pages/equipment-manuals>



# 2 USING PACIFIC HEAT WITH OCS SENSORS

This section addresses necessary precautions regarding Pacific Heat and your side impact air bag safety features, should your vehicle have this equipment. If your vehicle has an air bag system, your front passenger seat *may* be equipped with an **OCS sensor**.

## What is an OCS Sensor?

OCS is an acronym for Occupancy Classification System.

An OCS Sensor is a device which senses the presence of a person occupying the front right seat component.

Your vehicle's computer uses this data to activate the air bag safety feature for that seat component.

There are 3 (three) types of OCS sensors commonly in use:

**ATTENTION**

OCS SENSORS OF ANY TYPE MUST BE RE-CALIBRATED BY AN AUTHORIZED DEALERSHIP OR PERSON ANY TIME THE SEAT COVER IS REMOVED.

THIS WILL ENSURE THE CONTINUED SAFE FUNCTIONING OF YOUR VEHICLE AIR BAG DEPLOYMENT SYSTEM

### > Rail Mount OCS Sensor <

**OK** to use regular installation of Pacific Heat on seats



The seat heater pad does not interfere with OCS sensor  
Sensor is located on the seat rails near the floor

### > Silicon Gel Bladder OCS Sensor <

**OK** to use regular installation of Pacific Heat on seats



The seat heater pad does not interfere with OCS sensor  
Sensor resides in metal pan/seat support under the seat foam

### > OCS SEAT SENSOR MAT<

Located on the **FOAM SURFACE** of either cushion or backrest  
**IT IS NOT RECOMMENDED TO INSTALL ANY SEAT HEATER PAD WHERE A SEAT SENSOR MAT IS PRESENT**



## HOW TO SAFELY INSTALL PACIFIC HEAT On Seats with An OCS Sensor Mat

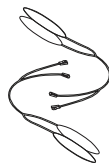
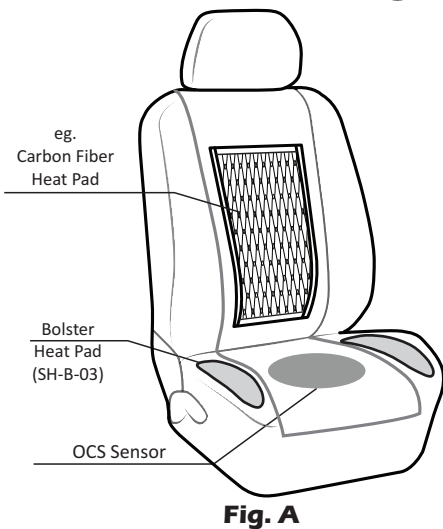

### You Will Need:

**Pacific Heat Bolster Mount  
Accessory Heating Pads  
(SH-B-03)**

- Remove the seat cover to determine the location of the seat sensor mat.

Replace the appropriate seat heater pad from Pacific Heat (Part# PH-Q2-CA) with a bolster seat heater pad from part# SH-B-03 **See \*\* Note Below**

- If sensor is on the central cushion (**Fig. A**) then use the bolster pad on the cushion bolsters.  
If sensor is on the central backrest (**Fig. B**) then use the bolster pad on the backrest bolsters.

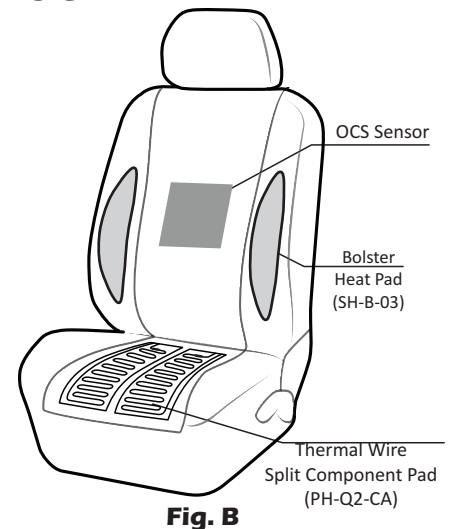

**\*\*Note:**  
Some vehicles have a sensor mat which extends out over the bolsters (e.g. Mini Cooper). Please be advised that it is not recommended to install ANY kind of seat heater pad over this sensor!

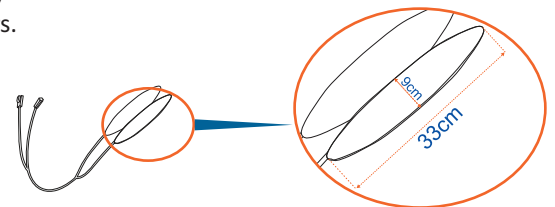

**Contact Your Supplier About Obtaining  
Pacific Heat Bolster Mount Accessory Pads  
Today !**

# 3 INSTALLATION GUIDELINES

**Before  
Beginning  
Your  
Installation:**

Disconnect vehicle battery terminals. Be sure to take note of any electronics security codes (navigation system, etc) prior to disconnection.

After disconnecting battery WAIT 10 MINUTES to allow capacitor to discharge.

Power will be maintained to safety systems.

**RECORD YOUR SEAT HEATER PART # & PAD ID#!  
THIS DATA IS REQUIRED TO REGISTER YOUR EQUIPMENT**

*Give yourself the upper hand....  
read the guide!*

*Things do change now and again...  
Keep Yourself on the Leading Edge! :)*

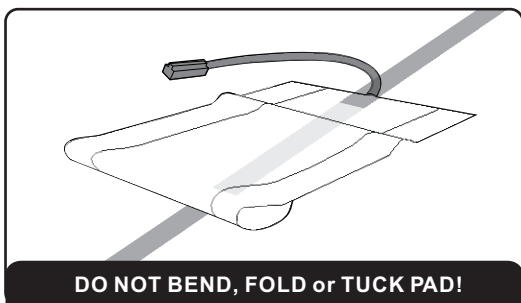

- QuadraTherm pads must be mounted such that they are contoured to the seat foam - free of any folds, bends, creases or gathers. The pads have adhesive strips on the backside.

**>Do not tuck the seat heater pad down into any of the listing channels<**

- The pad should have a solid bond to the foam such that it will remain COMPLETELY STATIONARY throughout its usage after the installation is complete. Double check to make sure that there will be no chance of shifting of the seat heater element once the upholstery has been re-installed.

**No modification of the pad is required to mount.  
Fitment between the listings is gained by  
adjusting the orientation/position  
of the pad components on the foam to find the best fit**

- Route all wires so that they are protected and not stressed while still allowing the seat components to move freely.

**ROUTE PAD LEAD WIRES SO THAT THEY EXTEND OUT THE REAR OF THE SEAT  
> NOT THE FRONT OF THE SEAT <**

**Premature wire fatigue can result from in/out passenger movement if  
the wires are extended out the front of your seat.**

- The area of installation must remain free of sharp objects to safeguard against unintended pad damage during and after your install.

- Do not modify seat covers or seams of seat with side impact air bag safety features.

- Consult the parts department of a car dealership that sells your vehicle to determine the presence of an air bag sensor on the front passenger seat.

Refer to Page 7, Section 2 For advice on how to deal with  
(OCS) Sensors

The installation method laid out in this manual affords the highest level of user safety and optimal performance of this equipment. Warranty claims will only be considered first and foremost when the installation procedure and method presented herein is fully adhered to.

**IMPORTANT**  
Please Read

An electronic copy of this manual can be found online at  
<https://pacificrestyling.com/pages/equipment-manuals>



# 4 INSTALLATION PROCEDURE

This seat heater kit has been engineered to operate on a 12V +/- 1 V system and should be connected into a vehicle's electrical circuitry as a 'switched' appliance. *For safety, seat heater appliances should be inoperable when your ignition is off.*

The installer should have advanced knowledge & experience with automotive electrical systems and use his/her experience to decide where to obtain source power from the vehicle.

You can standardize all your seat heater installs by using our power distribution bypass module and never worry about where to grab power from again!

(see page 5)

1. Park the vehicle securely; level and with the hand brake engaged.
2. Disconnect the positive battery cable (red) so you don't end up getting faulty system code readings.
3. REMOVE the front driver AND passenger seats from the vehicle and **FULLY REMOVE** the upholstery covers from the seat foam. Do not skip over this step as it is very important to achieving proper mounting of the heating pads.

Take all of the usual precautions to protect against inadvertent sucks-to-be-you damage of interior and/or exterior trim during seat removal

**REMEMBER - Do not install Pacific Heat under bonded seat upholstery !**  
eg. 2012 Dodge Caravan

4. Inspect the foam for damage and/or deterioration and repair and/or replace as necessary before installing aftermarket seat heaters.
5. Be mindful of the presence of any OCS sensors on the foam surface and refer to page 7 (seven) for advisement.
6. Observe the seat's listing channel layout and decide how you will layout out your pads and route your wires. Consider also, at this time, where you will mount your switch.

There are 2 identical heating pads in this seat heater kit:

- One (1) pad for the backrest
- One (1) pad for the seat bottom

The split component pad style of the QuadraTherm affords a turn-to-fit adjustment of the pad between the seat listing channels. Turn the pad components circularly on the foam surface to find their best fit & coverage BETWEEN the listing channels.

no pad modifications are necessary

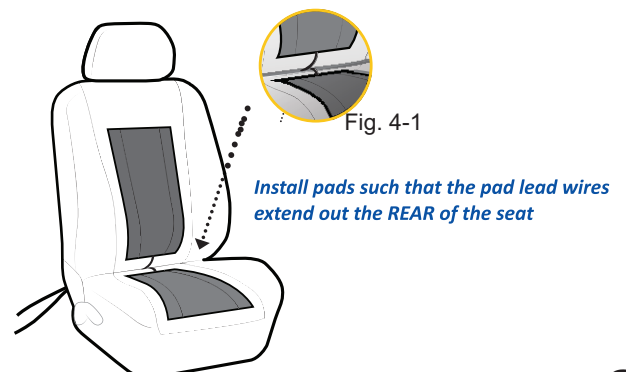

## INSTALLATION PROCEDURE CONTINUED . . .

7. Once you have settled on a layout for your pad components, Remove the adhesive tape backing on the back side of the pad and apply the pad to the foam in the planned location and orientation.

8. Firmly press the pad along the foam and rub it down to get a nice solid bond with the foam.

**MAKE SURE THE PAD IS NOT BENT, FOLDED OR CRUMPLED IN ANY WAY**

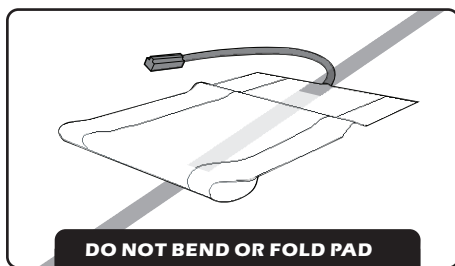

Fig. 3.2

9. Manage the seat heater pad lead wires so that they extend to the under-portion the seat bottom - routing the wires along listing channels.

There are numerous ways to accomplish this. Choose which ever way is most practical for the seat style you are working with.

To aid in wire routing, use a sharp utility knife to cut channels into the foam where suitable. Push wires down into these channels to conceal them.

One may use a long handle awl to punch a small hole through the foam to the underside to create a passage through which to route the pad lead.

10. The seat heater's main harness is typically mounted to the underside of the seat bottom your component pigtailed must reach the harness sockets comfortably. If more length is required to reach the harness, accessory part SH-R-EXTp must be utilized (ref. Table Pg 4).

Once you have finished mounting your pads and routing your wiring its time to move on to connecting your seat heaters to vehicle source power.

11. Locate an onboard accessory triggered power source which has the capacity to deliver up to 8 (eight) Amps of current.

The fuse box is a good place to start.

An experienced installer will have an intermediate to advanced knowledge of vehicle electrical systems layout and navigation.

12. If you wish to source power directly from the battery you must utilize a secondary harness built to handle the circuit. **Do not wire the seat heater directly to the battery.** Doing so will cause the battery to rapidly drain when the engine is not running.

To avoid system interferences source clean power from the battery use  
Part# PDM-ME1  
Pacific Power Distribution  
Bypass Module  
(ref: Pg 5)  
Lets you standardize all your installs &  
**SAVE TIME !**

13. Once your power source has been sorted out, extend the seat heater power wires under the vehicle trim and/or carpet to the harness you've mounted to the under side of the seat bottom.

Keep enough length to allow for the continued freedom of movement that the seat needs to have for it's usage adjustments.

**IMPORTANT**  
Please Read

The installation method laid out in this manual affords the highest level of user safety and optimal performance of this equipment. Warranty claims will only be considered first and foremost when the installation procedure and method presented herein is fully adhered to.

An electronic copy of this manual can be found online at  
<https://pacificrestyling.com/pages/equipment-manuals>

## INSTALLATION PROCEDURE CONTINUED . . .

### Mounting the Switch

14. Find a suitable trim surface that is flush and has enough space to fit the switch body & pigtail behind it. A common place to mount the switch is on the plastic moulding around the base of the seat bottom.

15. After deciding on your switch's location, drill an appropriately sized hole in the trim location and pull the pigtail through the hole. Recall that the switch head diameter is 23 mm (see back page for technical details). Route the wire such that it can connect with the main harness you have mounted under the seat bottom. Your component pigtails must reach the harness sockets comfortably. If more length is required to reach the harness, accessory part SH-R-EXTs must be utilized (see page 4 Part# Table).

16. The switch head is "keyed" (notched) so that it can be aligned properly in your mounting hole and secured in place to prevent it from rotating out of alignment. This is a raised rectangular feature located on the side of the switch head, opposite to the LED and is ~ 12mm in length. To utilize, cut a small notch on the inner edge of your mounting hole once it has been drilled out. After inserting the switch, rotate the head until the key "catches" in your notch. It is important to decide on your switch's final orientation BEFORE you create your lock notch.

Utilize the same mounting method for both the front driver and passenger seat heaters.

Once all of your electrical connections are made, test that the seat heater is getting power and working properly. It never hurts to double check your method . Check that appropriate connections have been used, and, that the procedure laid out in this manual has been followed.

Re-dress your seats & re-install them back into the vehicle, again being careful not to scratch any exterior/interior trim.

Plug in everything that needs to be plugged back in now with the addition of your seat heaters.

Accessory Component Part# SH-R-03sw: **TESTING & OPERATION**

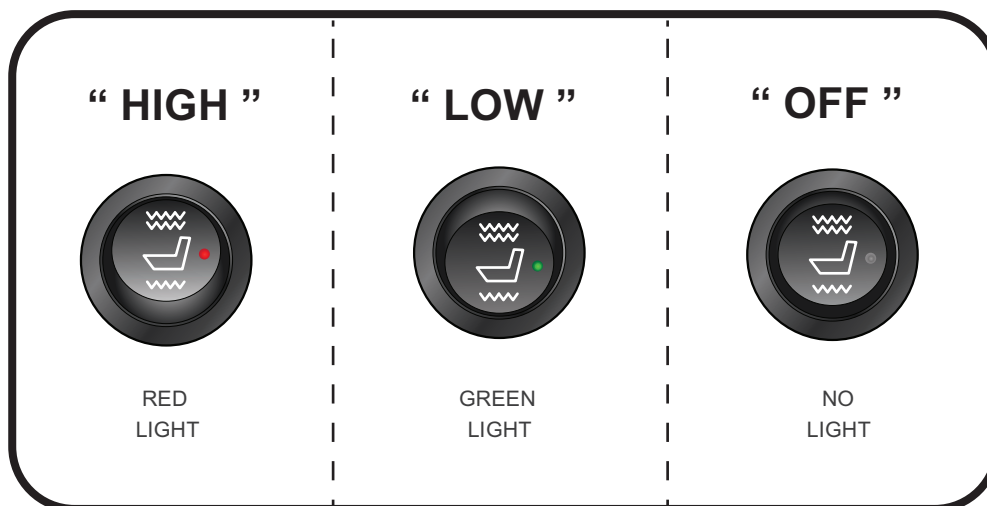

**IMPORTANT**  
Please Read

The installation method laid out in this manual affords the highest level of user safety and optimal performance of this equipment. Warranty claims will only be considered first and foremost when the installation procedure and method presented herein is fully adhered to.

An electronic copy of this manual can be found online at <https://pacificrestyling.com/pages/equipment-manuals>

# 5 USER SAFETY GUIDELINES/ Precautions

## WARNING

Excessive contact with any liquid will compromise the performance of the seat heater and reduce it's service life.

### DO NOT OPERATE YOUR SEAT HEATER:

- if the seat is wet/damp
- if the user is wearing wet/damp clothing

**DO NOT USE THE SEAT HEATER TO DRY WET CLOTHES OR OBJECTS !!**

### DO NOT OPERATE YOUR SEAT HEATER IF:

- at any time you feel that the seat heater is too hot and/or causing dizziness due to overheating.
- an unusual smell develops when the seat heating unit is switched on or if there is an uneven heat distribution.
- You experience HEAT FLUSH (Erythema ab igne (EAI))

A skin condition caused by long-term exposure to heat (infrared radiation).

Prolonged thermal radiation exposure to the skin can lead to the development of reticulated erythema, hyper-pigmentation, scaling and telangiectasias in the affected area.

This condition presents itself as a mottling on the skin similar in appearance to bruising/spider-veins.

Seek a professional medical opinion if you are concerned that this condition may be happening to you.

**The onus is on the end user to ensure that this seat heater equipment is used in a safe and responsible manner**

**This seat heater equipment DOES NOT shut off automatically.**

If the seat heater switch is left "on" when the vehicle is shut off, the seat heater will begin to heat as soon as the vehicle is started again

***BE MINDFUL of accumulating items on your passenger seat,***

Items that are heat sensitive can be severely damaged or destroyed and/or cause damage to your upholstery.

Neither your installer, nor Pacific Restyling Products Ltd shall be liable for any damages caused in this manner.

## USER SAFETY GUIDELINES CONTINUED . . .

1. DO NOT operate the seat heating unit unless a passenger is sitting on it. The passenger must be able to feel heat and be able to react accordingly. DO NOT allow people who experience difficulty with feeling heat including paraplegic persons, and young children to use the seat heating unit to avoid potential injury.
2. DO NOT leave heating unit switched on unsupervised. Caution needs to be taken when one is near the seat heater switch to avoid unintentional activation of the seat heating unit.
3. If the seat occupant feels an excessive temperature after the seat heating unit has been switched on; change to low temperature setting to reduce heat or switch off completely.
4. Do not allow heating pads to come into contact with metal or sharp objects such as knives, tools or anything which could penetrate or damage seat surface and heating pads.
5. The “High” setting of the seat heater is unsuitable for continuous operation as it puts load on the vehicle battery.
6. For an added level of safety, Pacific Heat Seat Heater pads have been chemically treated with a soluble fire retardant spray and are **FMVSS Compliant (FR302)**. The effectiveness of this treatment does diminishes over time and is adversely affected by exposure to liquid. We recommend using a NON-LIQUID method of upholstery cleaning to promote longevity of effectiveness for this treatment.
7. The recommended location of the seat heater fuse is within 12 inches of the tapped power source.
8. DO NOT put sharp or very heavy objects on top of the seat as they can damage seat surface and heating pads.
9. **When a seat heater is switched on, do not cover the seat with insulating materials including blankets, rugs, jackets, cushions, bags, handbags, retro-fitted seat mats, children’s seats, seat reinforcement etc. The function of seatheaters could be affected if it is operated while these materials are present. This can damage seat and cause injuries to seat occupant.**
10. DO NOT expose the heating pad to excessive moisture. Small amounts of the following liquids will not adversely affect the heating pad from being operated safely and continuously after it has dried out: perspiration, beverages (ex. Coffee, cola, mineral water, etc.), brine (Saltwater – 5% in solution), cleaning agents containing ammonia (10% by volume), cleaning agents containing alcohol (1-% by volume), cleaning agents for plastic or vinyl or soap water.

PLEASE ENSURE YOUR SEAT HEATER IS INSTALLED AS AN IGNITION TRIGGERED 12V ACCESSORY.

## 6 TROUBLE-SHOOTING

IF	THEN
Seat heater heats up but LED does not illuminate	LED Circuit is compromised. Switch replacement is recommended
Seat heater is not heating up LED not illuminating	Verify if the fuse has blown and change if necessary Check and make sure that all connector plugs are solidly seated to the appropriate socket mate.
Fuse repeatedly burns out	Make sure the proper fuse is in the holder (7.5A Mini Blade). Check with your mechanic for any underlying pre-existing electrical issues with the vehicle

**Your installer should be your first point of contact if you have any concerns about your equipment .**



### NEED ASSISTANCE?

Please contact your installer or local distributor.

**IMPORTANT**  
Please Read

The installation method laid out in this manual affords the highest level of user safety and optimal performance of this equipment. Warranty claims will only be considered first and foremost when the installation procedure and method presented herein is fully adhered to.

An electronic copy of this manual can be found online at  
<https://pacificrestyling.com/pages/equipment-manuals>



# 7 WARRANTY (LIMITED NON-TRANSFERABLE)

- ▶ PACIFIC HEAT SEAT HEATERS ARE WARRANTED TO BE FREE OF DEFECTS IN MATERIALS AND WORKMANSHIP FOR A PERIOD OF 3 Years / 58,000 Kilometers (~36,000 Miles) WHICHEVER OCCURS FIRST. THIS WARRANTY IS EXTENDED TO THE "ORIGINAL" END USER OF THE PRODUCT AND IS NOT TRANSFERABLE IF THE VEHICLE IS SOLD/GIVEN TO A NEW OWNER

WARRANTY COVERS EQUIPMENT ONLY AND DOES NOT COVER LABOR / FREIGHT FOR REPLACEMENT PARTS

## THE FOLLOWING VOIDS THIS WARRANTY:

1. If the "Installation Guidelines", "Pad Alteration - Procedure", and "User Safety Instructions" of this handbook are not followed completely and accurately. *(Incorrect Installation)*  
**Proof of correct installation is required with the submission of any and all warranty claims**  
The installation method laid out in this manual affords the highest level of user safety and optimal performance of this equipment. Warranty claims will only be considered first and foremost when the installation procedure and method presented herein (correct installation) is fully adhered to.
2. Any unauthorized repair made to the seat heater.
3. Modification of the seat heater harness/connectors. *(Modifications may be done to the PADS only in the way specified in this installation guide.)*

## WARRANTY LIMITATIONS:

1. Replacement Parts are covered for six months.
2. In the event of a burn on the seat cover and/or foam, the replacement of parts only are covered. Photo documentation is required and in most cases the parts must be returned for examination.
3. Damage to product in transit is not covered. This claim must be filed with courier.
4. Labor is not covered under this warranty - equipment only -

### ORIGINAL END USER'S RESPONSIBILITY:

Proof of purchase must be retained to claim warranty. Warranty is only valid if your product is registered within 30 days after installation.

## 8 PRODUCT REGISTRATION

- 1 Please retrieve the following information before you register your product.

PAD ID # : \_\_\_\_\_ (SEE DIAGRAM Page 4)  
required

Installation Company : \_\_\_\_\_

Purchase Date : \_\_\_\_\_ Installation Date : \_\_\_\_\_

Vehicle Make : \_\_\_\_\_ Vehicle Model : \_\_\_\_\_

Vehicle Year : \_\_\_\_\_

Mileage at Installation : \_\_\_\_\_ COMPLETE VIN # : \_\_\_\_\_

- 2 EMAIL above details to : [info@pacificrestyling.com](mailto:info@pacificrestyling.com)

PLEASE SUBMIT YOUR REGISTRATION DETAILS FROM A VALID EMAIL ADDRESS FOR YOU THAT YOU CHECK ON A REGULAR BASIS. YOUR REGISTRATION NUMBER WILL BE SENT BACK TO THE EMAIL ADDRESS THAT YOU PROVIDE WITHIN 48-72 BUSINESS HOURS OF YOUR REGISTRATION SUBMISSION. PLEASE BE SURE TO INCLUDE YOUR FULL VIN NUMBER.

# Technical Details:

## Part#

### PH-Q2-CA

#### Battery System:

-For use with 12V ±1V systems only

#### Heating Pads:

- Rectangular Split Components  
L: 255 mm; W: 125mm /component  
Pad Lead: 660 mm  
-Component Bridge: 220 mm  
-Wire Conduit:  
Flexible Braided Nylon Mesh

#### In-Pad Resistor:

Continuous Thermal Wire  
Amps Drawn - High > ~4.3A  
Amps Drawn - Low > ~ 1.3A  
(Bench Values @ 13.8V )

#### Pad Substrate:

- Non-Woven Synthetic Fibres  
- FMVSS Compliant (FR302)  
*\*see pg. 13; Item 6 for handling precautions*

#### Mounting:

Pad components have self-adhesive strips on undersides for secure bonding to seat foam.

#### In-Pad Thermal Switch:

-KW-C3 Bi-Metal Thermal Protector  
-Low-Profile  
-Rated 65° C  
Approbations:



#### Switch:

-Dual Temperature (High/Low)  
-LED Indication:  
-Illuminates RED (High)  
-Illuminates GREEN (low)  
-Rocker style; black  
-23mm Round Body  
-Round Bezel  
-Center Off Position  
-38 cm Pigtail  
-4-pin in-line connector plug  
Approbations:

  
**Rating:**  
16A/125VAC  
10A/250VAC

  
**Rating:**  
10A/125VAC  
6A/250VAC

#### Fuse:

Mini Blade Fuse; 7.5A (brown)

#### Fuse Holder:

In-Line; Waterproof;  
Free-Hanging Fuse Boot;  
16AWG Lead Wires

#### Kit Contents:

2 - Pads  
1 - Switch  
1 - Harness  
1 - 5-pin Automotive Relay  
1 - Fuse  
1 - Fuse Holder  
5 - Cable Ties  
Installation Guide -  
See URL Below for Access To  
Electronic Copy

*1 - can of beer (ya...no...sorry! )  
1 - pepperoni pizza (ya...no... sorry !)  
but if we could, we would !*

The installation method laid out in this manual affords the highest level of user safety and optimal performance of this equipment. Warranty claims will only be considered first and foremost when the installation procedure and method presented herein is fully adhered to.

**IMPORTANT**  
Please Read

An electronic copy of this manual can be found online at  
<https://pacificrestyling.com/pages/equipment-manuals>

Install Date: \_\_\_\_\_

Installer's Notes:

**\*\*Be sure to jot down the PAD ID# stamped on these seat heater pads\*\***

**You'll need this data to register your seat heaters !**

**Pad ID: 112023-SPHS-PHQ2-A**

**June 2024**

