

## Toyota 2012-19 Tundra V8-5.7L Cold Air Intake

Thank you for choosing Rough Country for all your vehicle needs.

Please read instructions before beginning installation. Check the kit hardware against the kit contents shown below. Be sure you have all needed parts and know where they go.

If question exist, please call us @1-800-222-7023. We will be happy to answer any questions concerning this product.

Check all fasteners for proper torque. Check to ensure for adequate clearance between all components.

Periodically check all hardware for tightness.

### ▲ NOTICE NOT FOR SALE IN CALIFORNIA

#### KIT CONTENTS:

- 3.5" Clamp x1
- 4" Clamp x3
- Air Filter Clamp x1
- 3.5" to 4" Rubber Adapter x2
- Intake Tube x1
- Heat Shield x1
- Seal x1
- Filter Adapter x1
- Air Filter x1
- 2 Hole Bracket x1
- 90 deg. Bracket x1
- 45 deg. Bracket x1
- 1/8"-1/4" NPT Barbed Hose Fitting x1
- 1/2"-1/4" NPT Barbed Hose Fitting x1
- 1/2" Double Barbed Coupler x1
- 1/2" I.D. x 7"L. Hose x1
- Bracket Spacers x4

#### TOOLS NEEDED:

- Pliers
- Flat Head Screwdriver
- Phillips Screwdriver
- 2.5 mm Allen Wrench
- 4mm Allen Wrench
- 9/16 Wrench
- 10mm Wrench and Socket
- Razer Knife

#### HARDWARE INCLUDED:

- Stud x1
- Hex Stud Extension x1
- 4mm x 8mm Button Head Bolt x2
- 6mm x 16mm Button Head x2
- 6mm lock washers x 5
- 6mm x 16mm Hex Head Bolt x3
- 6mm x 20mm Hex Head Bolt x4
- 6mm Flat Washer x13
- 6mm Nylock Nut x4



## INSTALLATION INSTRUCTIONS

1. Place the vehicle in park. Turn the engine off.
2. Disconnect the positive wire from the battery.
3. Remove the intake cover from the engine by lifting straight up. **See Photo 1 and 2.** Set aside in a safe place for later use.

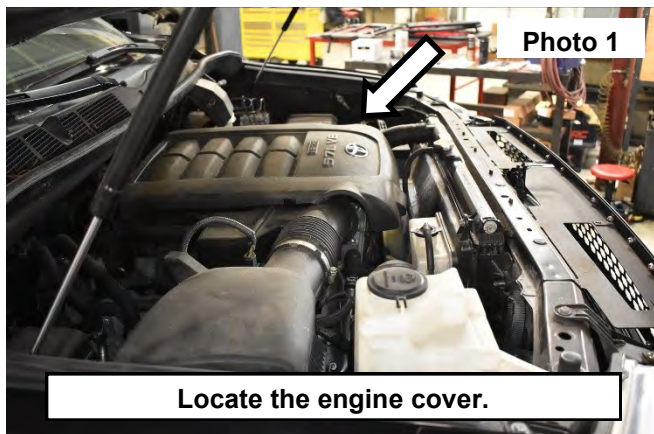

4. Using a pry tool release the wire loom clip from the filter box. **See Photo 3.**
5. Disconnect the mass air flow sensor plug. **See Photo 4.**

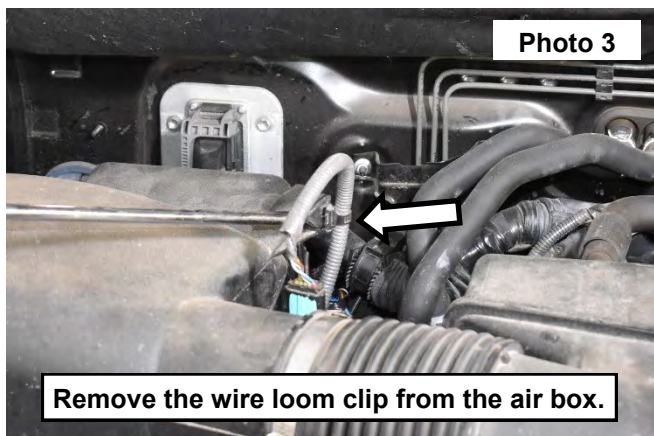

6. Loosen the clamp around the throttle body using a 10mm socket. **See Photo 5.**
7. Use pliers to open the clamp on the hose attached to the intake chamber and slide the clamp back, then remove the hose from the intake chamber. **See Photo 6.**

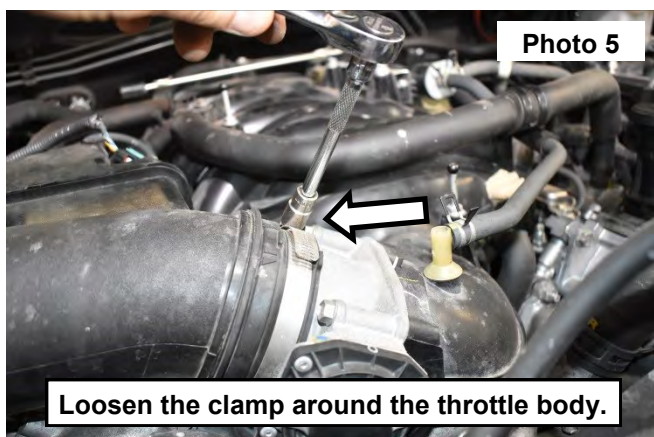

8. Remove the small hoses on the end of the intake chamber. **See Photo 7.**
9. Release the filter lid clamps then remove the flex tube from the throttle body, removing the part from the vehicle. **See Photo 8.**

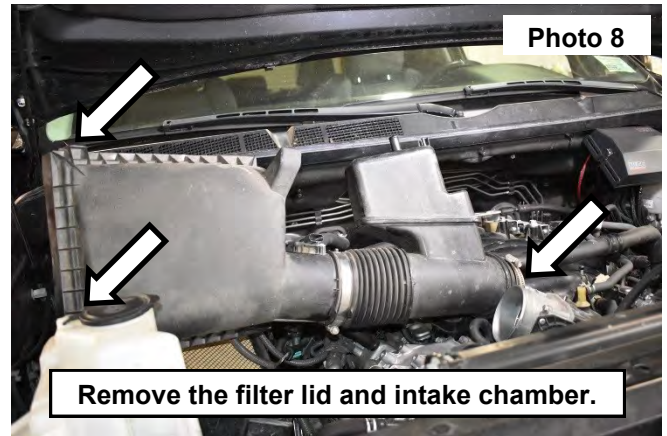
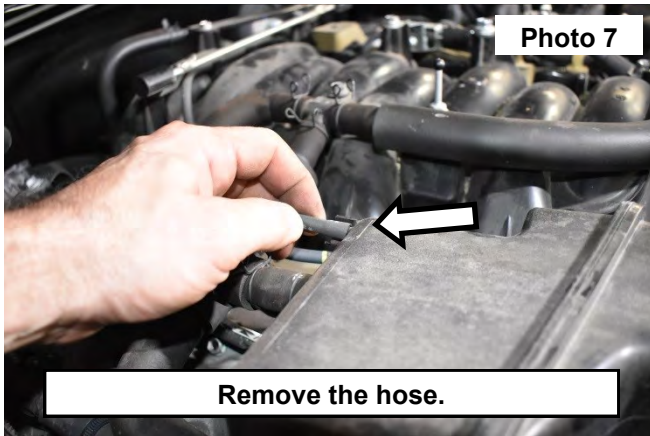

10. Remove the 2 bolts in the front the air filter box using a 10mm socket. Lift the air filter box up pulling to the inside of the fender to remove the rubber gromet holding the rear of the air filter box into the fender. Then remove the air filter box tube from the vehicle. **See Photos 9 and 10.**

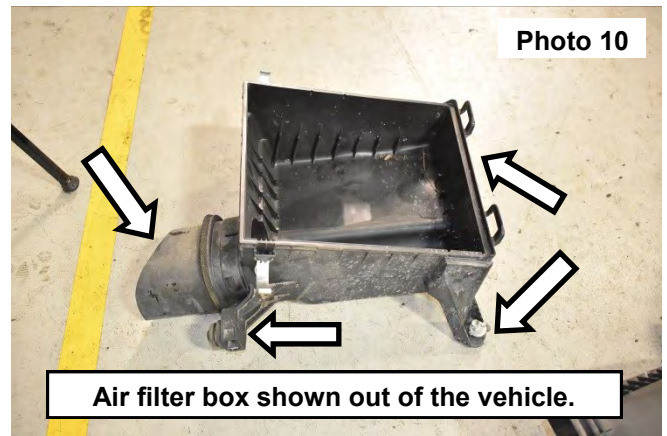

11. Remove the mass air flow sensor from the filter lids exit tube using a Philips screw driver. **See Photo 11.**
12. Install the mass air flow sensor into the Rough Country intake tube using the supplied 4mm-0.07 x 8mm button head allen bolts. Tighten using a 2.5mm allen wrench. **See Photo 12.**



13. Install the barbed fittings into the intake tube.
14. Install the 1/8" barbed hose into the hole closest to the edge of the tube and the 1/2" barbed fitting into the 2nd hole in the intake tube. Use a 9/16" wrench. **See Photo 13.**
15. Install the air filter adapter onto the heat shield using 2 of the supplied m6 x 1.00 x 16mm button head bolt, (2) m6 lock washers and (2) m6 flat washers. Tighten using a 4mm allen wrench. **See Photo 14.**

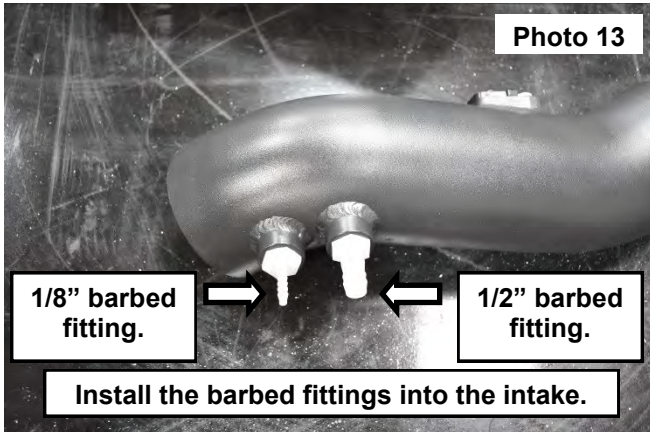

16. Install the 2 supplied M6-1.00 x 20mm hex head bolts and flat washer into the heat shield, then install the 2 supplied spacers onto the 2 bolts. **See Photo 15.**
17. Install the bracket with 2 holes onto the bolts and spacers. Secure using the supplied m6 flat washers and M6-1.00 nylock nuts. Tighten using a 10mm socket and wrench. **See Photo 16.**

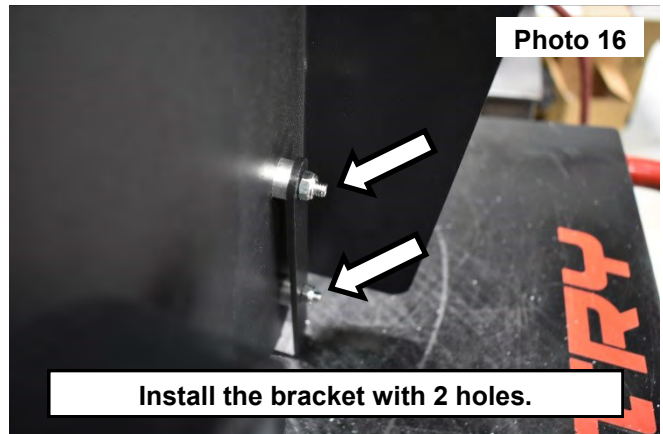
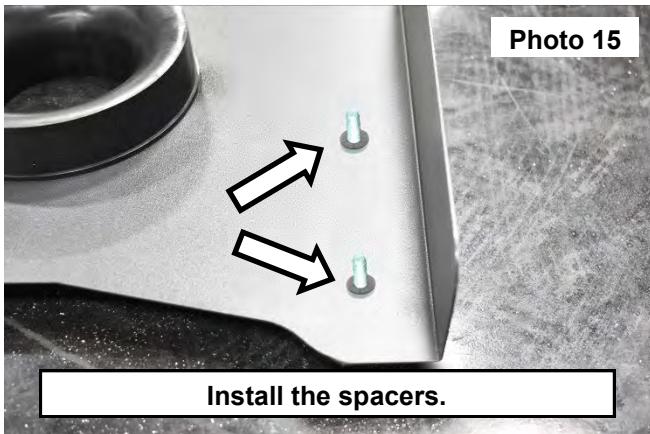

18. Install 1 of the supplied 6mm-1.00 x 20mm hex head bolts and M6 flat washer into the inside of the heat shield, then install 1 of the supplied spacers onto the bolt. Install the bracket with 2 bends onto the inside of the heat shield and secure using a 6mm flat washer and 6mm-1.00 nylock nut. **See Photo 17.**
19. Locate the bracket with one 90 deg. bend. Install 1 of the supplied 6mm-1.00 x 20mm hex head bolts and 6mm flat washer into the bracket. Install 1 spacer onto the bolt in the bracket, install the assembly into the outside of the heat shield secure using a 6mm flat washer and 6mm-1.00 nylock nut. Tighten using a 10mm wrench and socket. **See Photo 18.**

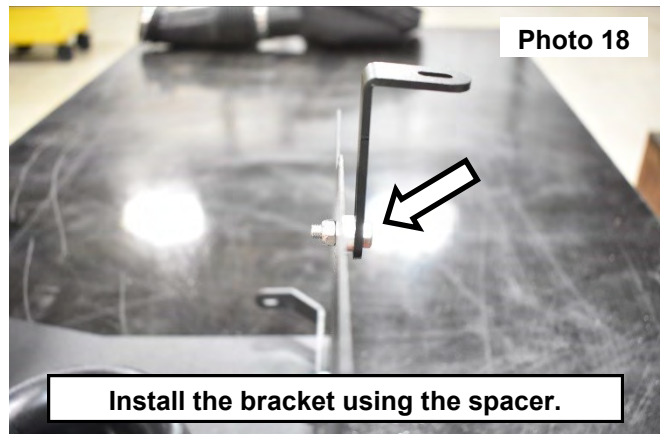
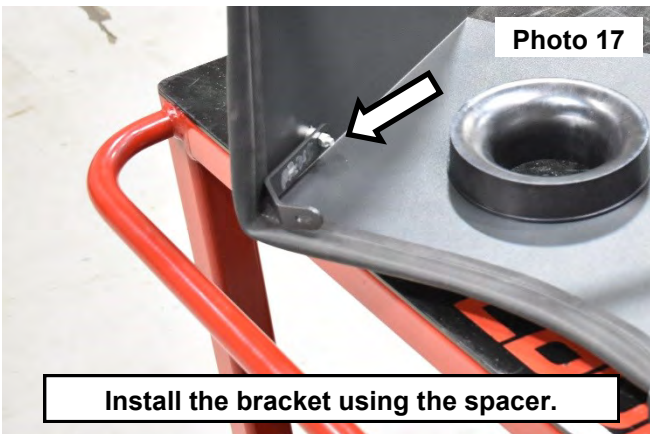

20. Install the seal around the heat shield. **Trim as needed to remove excess gasket. See Photo 19.**
21. Install the rubber flex tube onto the filter adapter using the supplied clamps. Tighten using a flat head screw driver. **See Photo 20.**

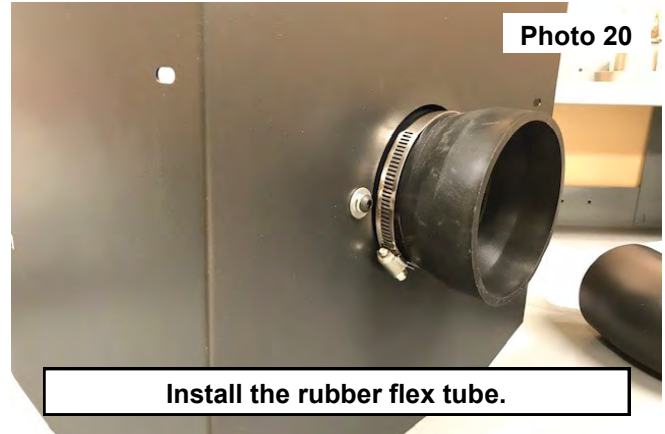

22. Install the 3.5" to 4" rubber adapter onto the throttle body using the supplied clamp. Tighten using a flat head screw driver. Install the outer clamp onto the rubber boot. **See Photo 21.**
23. Install the rough country intake tube into the rubber boot on the throttle body. Do not tighten the clamp at this time. **See Photo 22.**

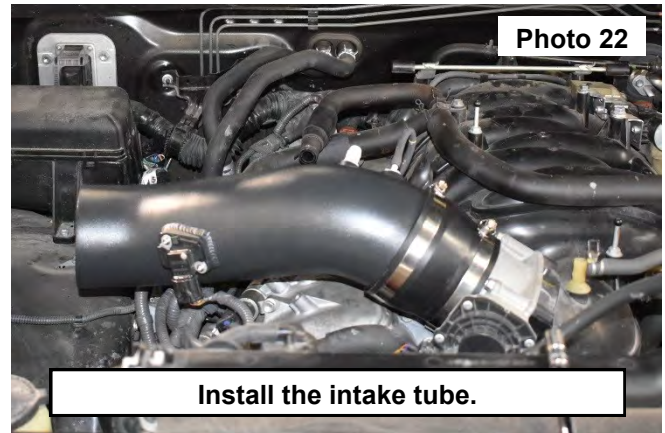
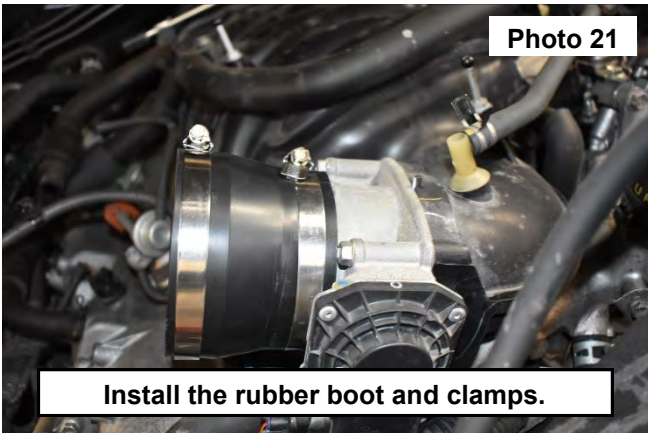

24. Install the heat shield into the vehicle, fit the flex tube onto the intake tube. Adjust the intake tube and tighten the clamps on each end of the intake tube using a flat head screw driver. **See Photo 23.**
25. Secure the ground wire under the heat shields bracket to the vehicle using the 3 supplied 6mm-1.00 x 16mm hex head bolt and 6mm flat washers into the 3 brackets. Tighten using a 10mm socket. **See Photo 24.**

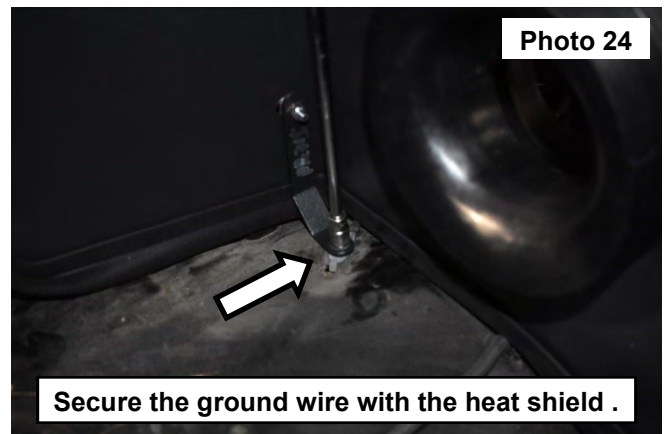

26. Connect the Mass Air Flow sensor plug. **See Photo 25.**
27. Install the 1/2" double barbed hose connector into the hose removed from the intake chamber, then slide the clamp over the hose to secure the fitting. Install the supplied 1/2" hose onto the double barbed fitting and the 1/2" fitting installed into the intake. Install the remaining OE hose onto the 1/4" barbed fitting on the intake. **See Photo 26.**

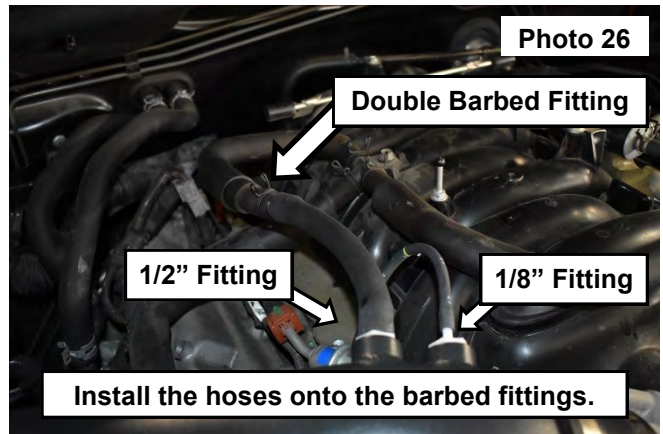

28. Install the air filter using the supplied clamp. Tighten the clamp using a flat head screw driver. **See Photo 27.**
29. Remove the mounting stud from the front side of the intake. Using a 10mm socket. **See Photo 28.**

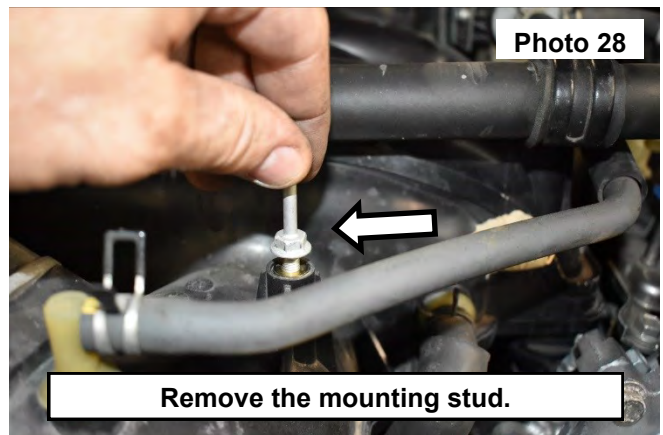
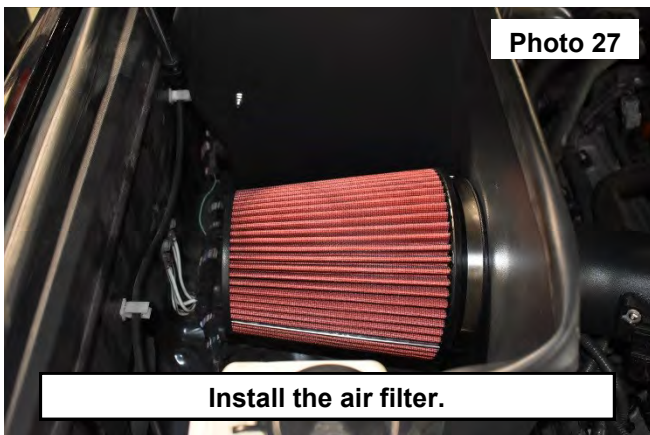

30. Install the supplied threaded extension into the intake and install the hex extension. Tighten using a 10mm socket. Install the OE mounting stud into the extension. Tighten using a 10mm wrench. **See Photo 29.**
31. Install the cover onto the intake and the stud mount. **See Photo 30.**
32. Connect the positive wire to the battery.

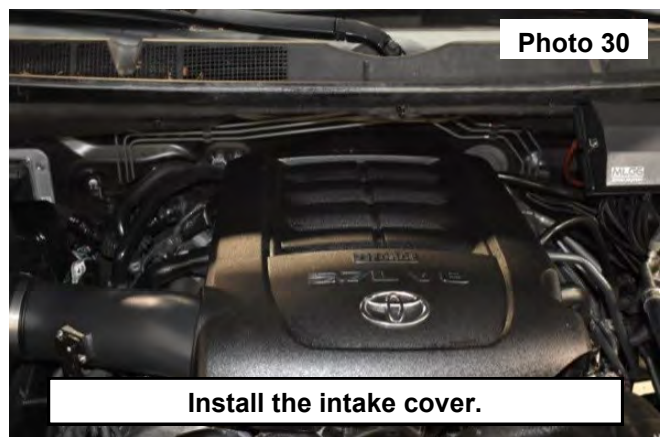
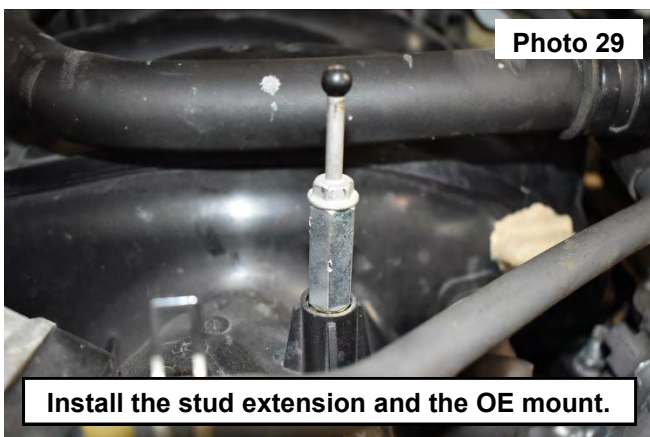

By purchasing any item sold by Rough Country, LLC, the buyer expressly warrants that he/she is in compliance with all applicable, State, and Local laws and regulations regarding the purchase, ownership, and use of the item. It shall be the buyers responsibility to comply with all Federal, State and Local laws governing the sales of any items listed, illustrated or sold. The buyer expressly agrees to indemnify and hold harmless Rough Country, LLC for all claims resulting directly or indirectly from the purchase, ownership, or use of the items.

